



Project: \_\_\_\_\_  
 Location: \_\_\_\_\_  
 Item #: \_\_\_\_\_  
 Quantity: \_\_\_\_\_

## Reach-In Blast Chiller

### VBC MODELS — VBC-100

Stainless steel  
 exterior and  
 interior.

Blast Chill/Storage Refrigerator



VBC-100

### Standard Features

- Two Operational Features:
  - Blast chill processing refrigerator
  - +38°F storage refrigerator
- Operational Indicator Panel with Microprocessor:
  - Blast Chill Cycle Controlled Automatically by Either Food Probes or Digital Timer
  - Four (4) Preset Chilling Times: 30, 60, 90, 240 Minutes
  - Cabinet Temperature Digital Display
  - Food Temperature Digital Display
  - Defrost Mode Indicator
  - Power Failure Alarm
  - Three (3) Food Probes with Digital Temperature Indication
- Seven (7) Day Temperature Recorder Printout on Demand
- Stainless Steel Front, Sides, Door and Interior
- Flush Mounted Doors, Anti-Condensation Heaters and Removable Magnetic Gaskets
- Twelve (12) Adjustable White Resin Coated Wire Shelves
- Heavy Duty Swivel Casters with Locking Brakes on the Front
- Condensate Disposed of Automatically
- Large Surface Area Evaporator and Velocity Fan Contained in a Separate Service Compartment
- Automatic Defrost
- Environmentally Free R-134a Refrigerant

The Victory Blast Chiller is designed to reduce the temperature of 2" thick, uncovered food from 160°F to 38°F in approximately 90 minutes.

### Cabinet:

The cabinet front, sides, and door are constructed of heavy gauge polished stainless steel to maintain an attractive appearance after years of heavy use. Over 2 1/2" of foamed-in-place polyurethane insulation throughout the cabinet ensures the ultimate in energy efficiency.

### Doors:

The self-closing door is securely mounted on a hinge, which has a lifetime guarantee. The door has an easy-to-replace magnetic balloon gasket to prevent the cold air from escaping. Door heater is standard to prevent condensation from forming on the cabinet front. The interior door liner is constructed of heavy gauge stainless steel.

### Control Panel:

The easy-to-use microprocessor controls feature built-in alarms and can control the chilling process with the temperature probes or a digital timer. The digital timer can be programmed with four preset chilling times for specific food products. The built-in printer allows for simplified documentation and easy HACCP record keeping.

Approvals:



Victory Refrigeration specification sheets are available online at [www.victory-refrig.com](http://www.victory-refrig.com).

CHARACTERISTICS	VBC-100
Capacity (lbs./90 mins.)	100
Width, Overall	43 <sup>3</sup> / <sub>8</sub>
Depth, Overall	40 <sup>5</sup> / <sub>8</sub>
Depth, Door Open 90°	66
Height (incl. casters)	81
Clear Door Width	21 <sup>3</sup> / <sub>8</sub>
Clear Door Height	51 <sup>3</sup> / <sub>8</sub>
No. of Shelves	12
Cabinet Voltage	208/60/3
Feed Wires (with Ground)	3
Total Amperes	8.6
10 Ft. Cord Installed, (No Plug)	

Crated dim. & wts.	Ht.	Width	Depth	Lbs
VBC-100	84	46 <sup>1</sup> / <sub>2</sub>	43 <sup>1</sup> / <sub>2</sub>	659

**REFRIGERATION DATA**

	Refrigerant	Compressor	BTUH*
VBC-100	R-404A	2 H.P.	12098

\*BTUH @ 90° F. Ambient, +14° F. Evaporator

Dimensional tolerance ± 1/4" Metric dimensions (MM)

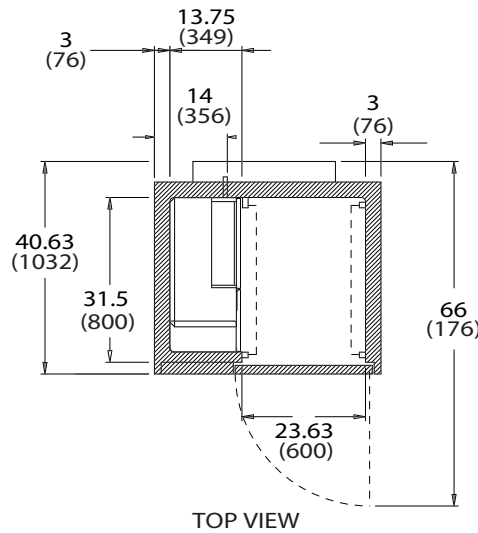

**NOTE:** If cabinet is located directly against wall and/or under low ceiling, a minimum clearance of 2" is required.

We reserve the right to change specifications and product design without notice. Such revisions do not entitle the buyer to corresponding changes, improvements, additions or replacements for previously purchased equipment.

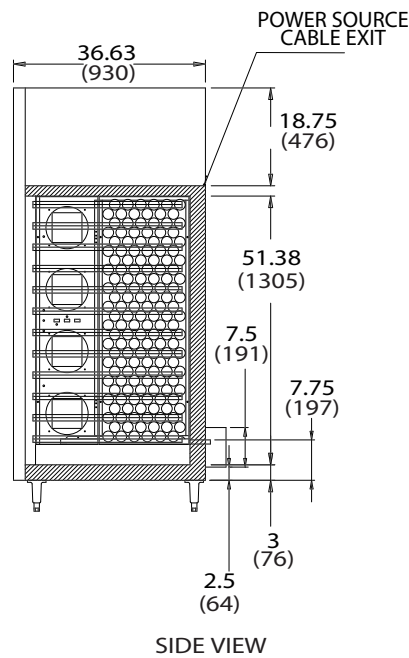
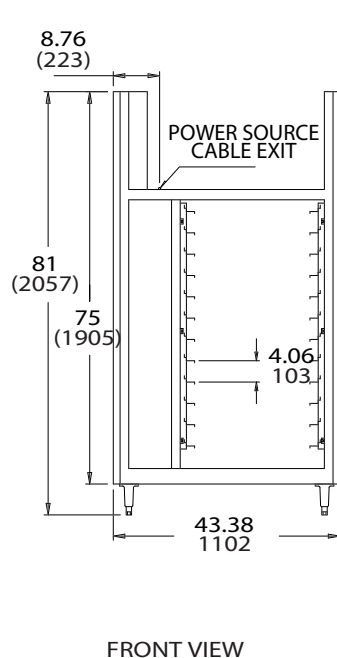

Continuous product development may necessitate specification changes and design without notice.



Victory participates in the KCL CADalog, the most current source of CAD symbols for foodservice designers worldwide. Symbols include standard equipment in plan, side, front and 3-D views, layered for FEDA/FCSI recommended guidelines.